

A1

All dimensions to be checked on site. Figured dimensions take preference over scaled dimensions. Any errors or discrepancies to be reported to the Architects. This drawing may not be edited or modified by the recipient.

Copyright and ownership of this drawing is vested in RKD Architects, whose prior written consent is required for its use, reproduction or for publication to any third party. All rights reserved by the law of copyright and by international copyright conventions are reserved to RKD Architects and may be protected by court proceedings for damages and/or injunctions and costs. RKD Architects' Quality Management Systems are certified to ISO 9001:2015.

Notes:

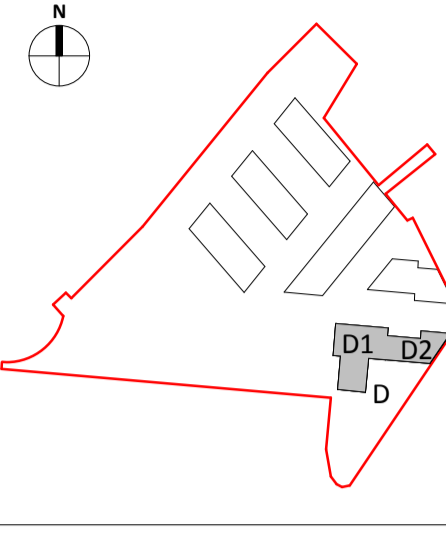

All levels shown are to the Irish Transverse Mercator (ITM) and are displayed in meters (m). All levels shown relate to the Malin Head datum. All dimensions shown in millimeters (mm). Symbol indicates top of floor level and relates to Malin Head datum

USE

- STUDIO APARTMENT
- 1 BED APARTMENT
- 2 BED APARTMENT
- 3 BED APARTMENT
- INTERNAL RESIDENTIAL AMENITIES
- RETAIL
- COMMUNITY
- ANCILLARY USE

Rev.	Date	Description
A	OCT 2019	Issued for Planning Application Submission

STATUS: **PLANNING**

PROJECT: The Connolly Quarter

PROJECT ADDRESS: Lands to the Rear of Connolly Station, Dublin 1

DWG TITLE: BLOCK D PLAN_LEVEL 05

DWG NO.: 18135-ARROW-D-05-DR-A-1105

REV. PROJECT NO. SCALE: A 18135 1 : 200

DATE JUN 19 DRN ILA CHK UR

RKD

59 Northumberland Rd, Ballsbridge, Dublin 4, D04 W P86, Ireland

+353 1 668 1055, info@arrowarchitects.com, www.arrowarchitects.com

ARROW

Nørre Fasanvej 13, 4th fl., DK-1364 Copenhagen K, Denmark

+45 4226 2860, info@arrowarchitects.com, www.arrowarchitects.com

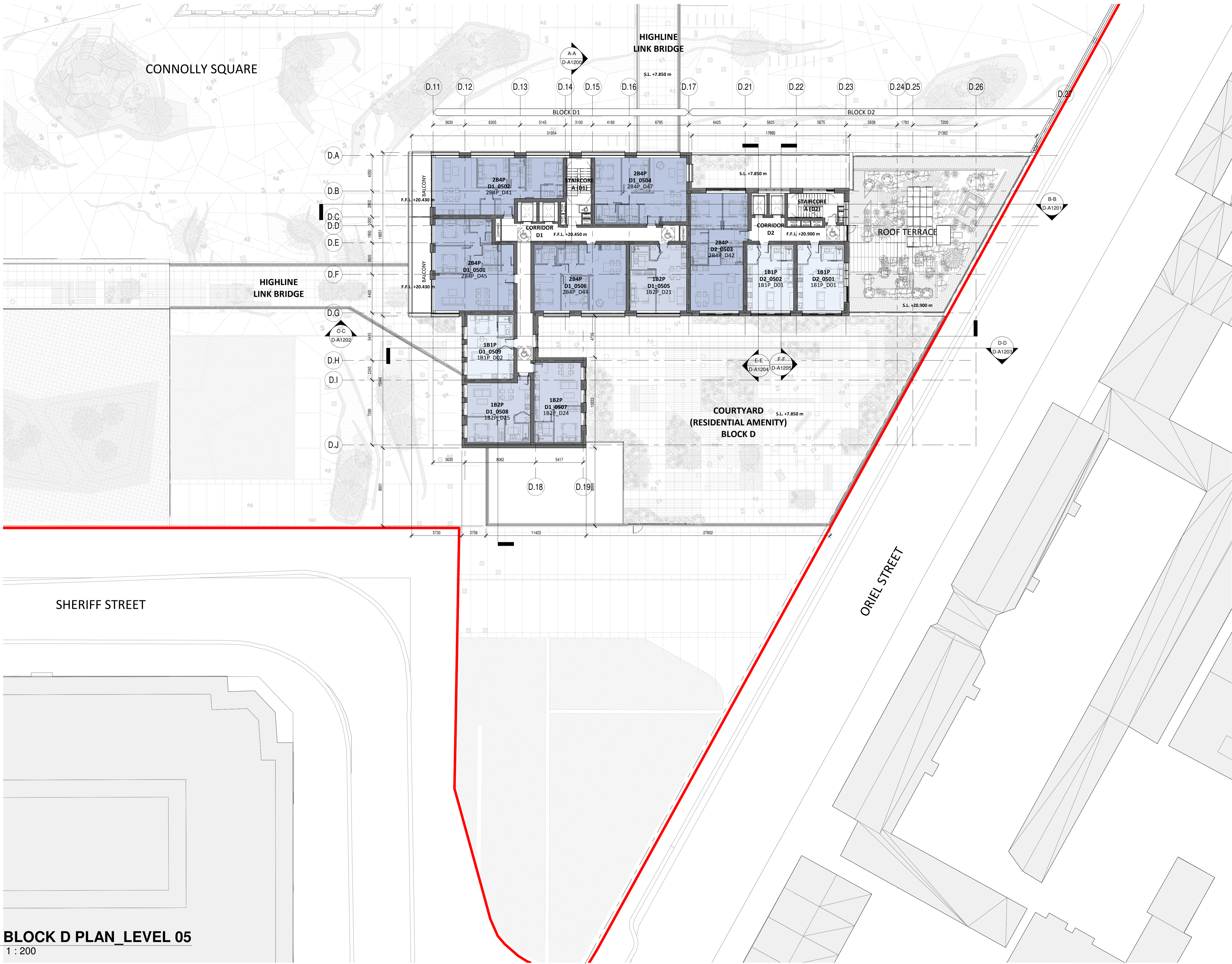

1 BLOCK D PLAN_LEVEL 05
1 : 200